

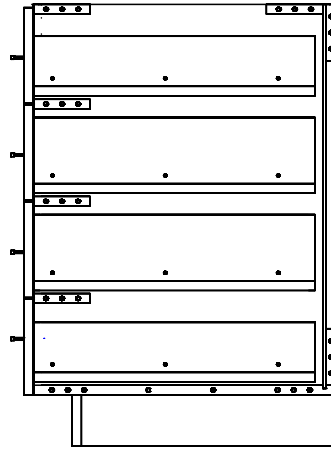

DRAWER BANKS

1. Drawer faces can be any size
2. Holes are drilled for specified hardware eliminating the need to count holes for placement
3. Drawer stretchers are optional
4. Cabinets can be ordered with integral toe
5. Drawer boxes can be ordered with cabinet
6. Cabinet can be constructed with stretchers or a full top



DB1D_1

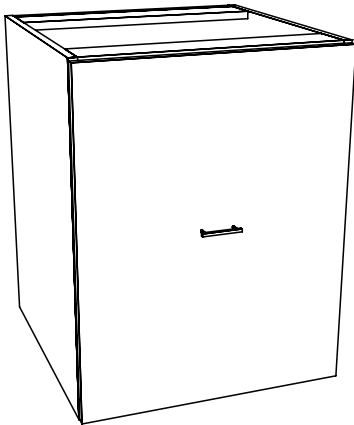

Drawer - 1 Float

DB2

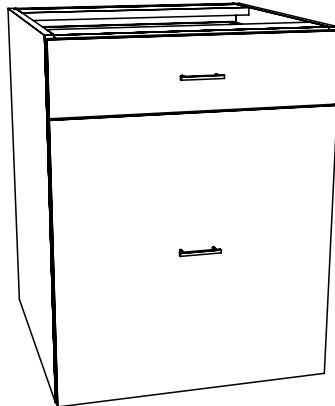

Drawer - 2 Custom (Specify Sizes)

DB2D_1

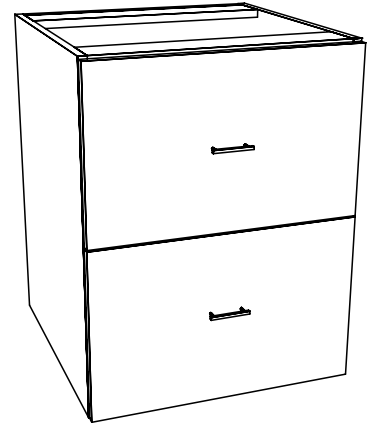

Drawer - 2 Float

DB3

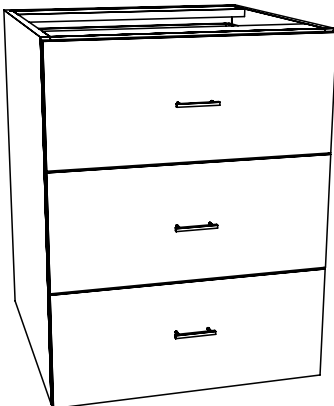

Drawer - 3 Custom (Specify Sizes)

DB3D_1

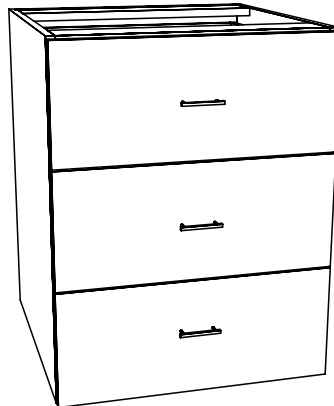

Drawer - 3 Float

DB3D_2



Drawer - 1 Regular, 2 Float



DRAWER BANKS

DB3D_3

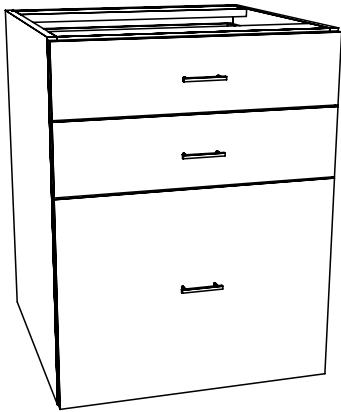

Drawer - 2 Regular, 1 Float

DB4

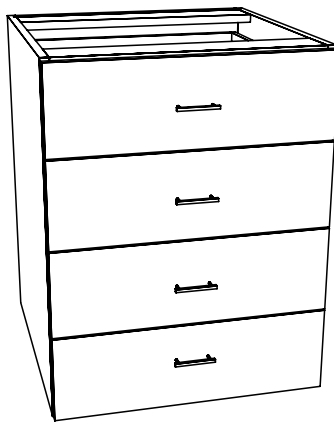

Drawer - 4 Custom (Specify Sizes)

DB4D_1



Drawer - 4 Float

DB4D_2

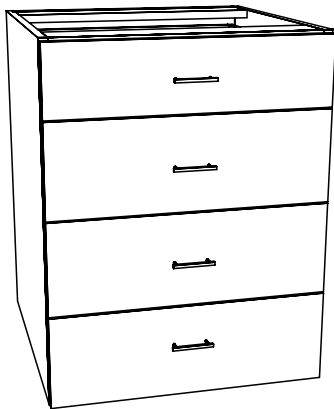

Drawer - 1 Regular, 3 Float

DB4D_3

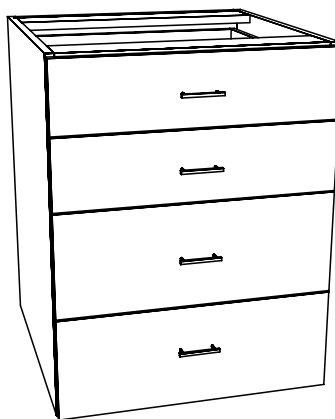

Drawer - 2 Regular, 2 Float

DB4D_4

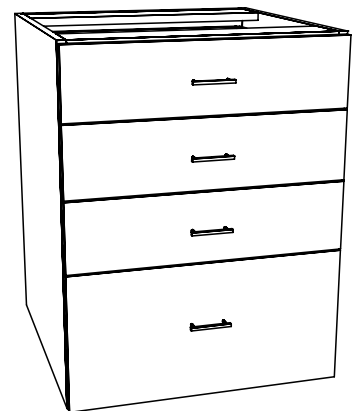

Drawer - 3 Regular, 1 Float

DB5



Drawer - 5 Custom (Specify Sizes)

DB5D_1

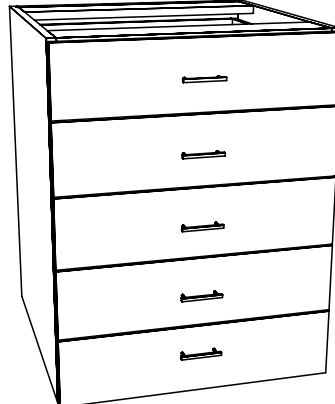

Drawer - 5 Float

DB5D_2

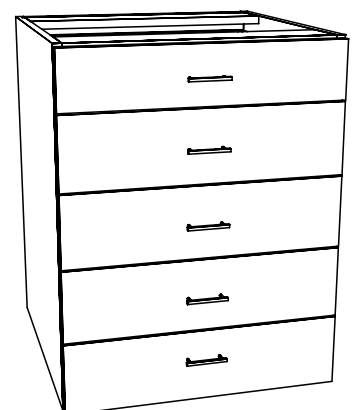

Drawer - 1 Regular, 4 Float



DRAWER BANKS

DB5D_3



Drawer - 2 Regular, 3 Float

DB5D_4



Drawer - 3 Regular, 2 Float

DB6

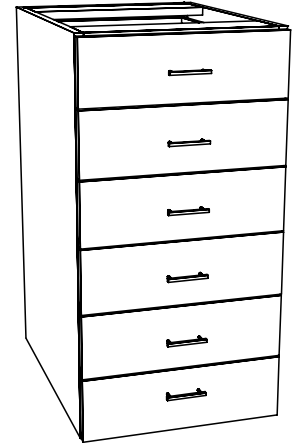

Drawer - 6 Custom (Specify Sizes)

DB6D_1

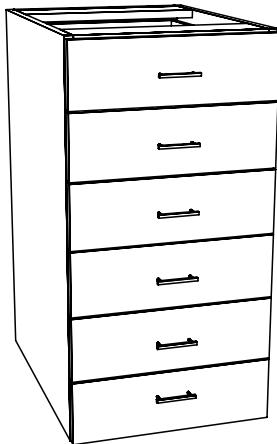

Drawer - 6 Float

DB6D_2

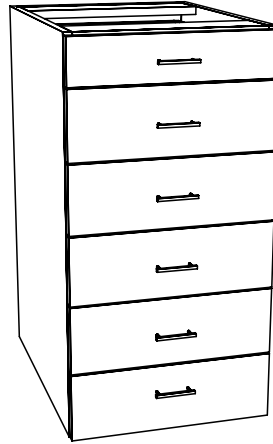

Drawer - 1 Regular, 5 Float

DB7

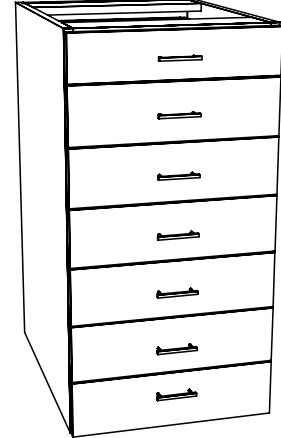

Drawer - 7 Custom (Specify Sizes)

DB7D_1

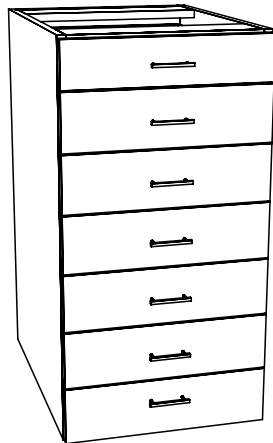

Drawer - 7 Float

DB7D_2

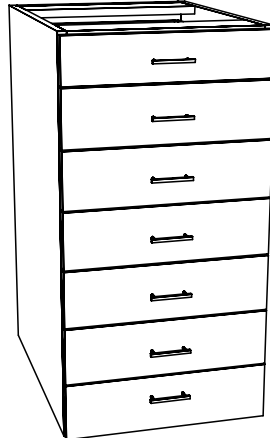

Drawer - 1 Regular, 6 Float