

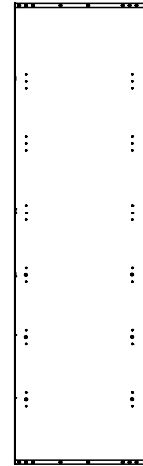

CLOSET

1. Special line bore drilling (3-hole pattern every 10")
2. Line bore holes can be deleted
3. Closet pole drilling from bottom 40", 70", 80"
4. Closet pole holes can be relocated upon request
5. Closet pole holes can be deleted
6. Closet pole hole pattern can be 2-hole verticle, or 3-hole circle
7. The closet pole distance from inside of back of cabinet can be adjusted
8. Dowel construction only



TC0D

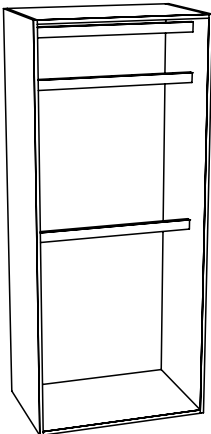

Shown With Closet Poles Only
Tall Closet - 0 Door

TC0D

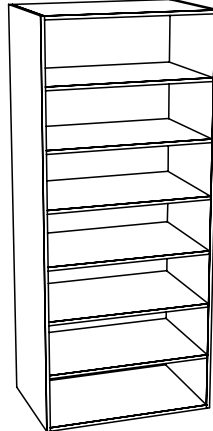

Shown With Adjustable Shelves Only
Tall Closet - 0 Door

TC1D

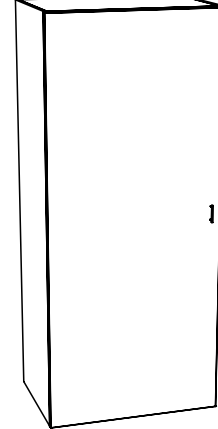

Tall Closet - 1 Door

TC2D

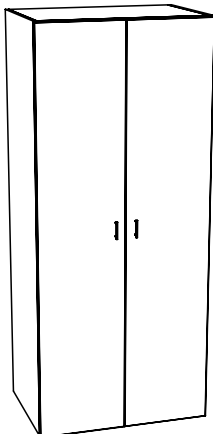

Tall Closet - 2 Door

TC0DPCL

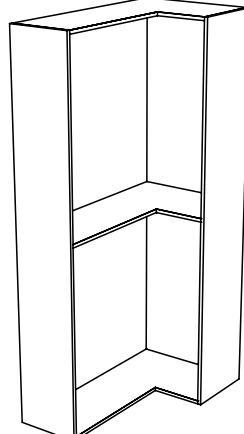

Tall Closet - 0 Door, Pie Cut Left

TC0DPCR

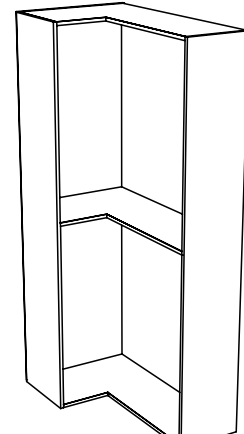

Tall Closet - 0 Door, Pie Cut Right